

FOR CONTINUATION.  
 SEE DRAWING NO. 0022

FOR CONTINUATION.  
 SEE DRAWING NO. 0011

FOR CONTINUATION.  
 SEE DRAWING NO. 0009

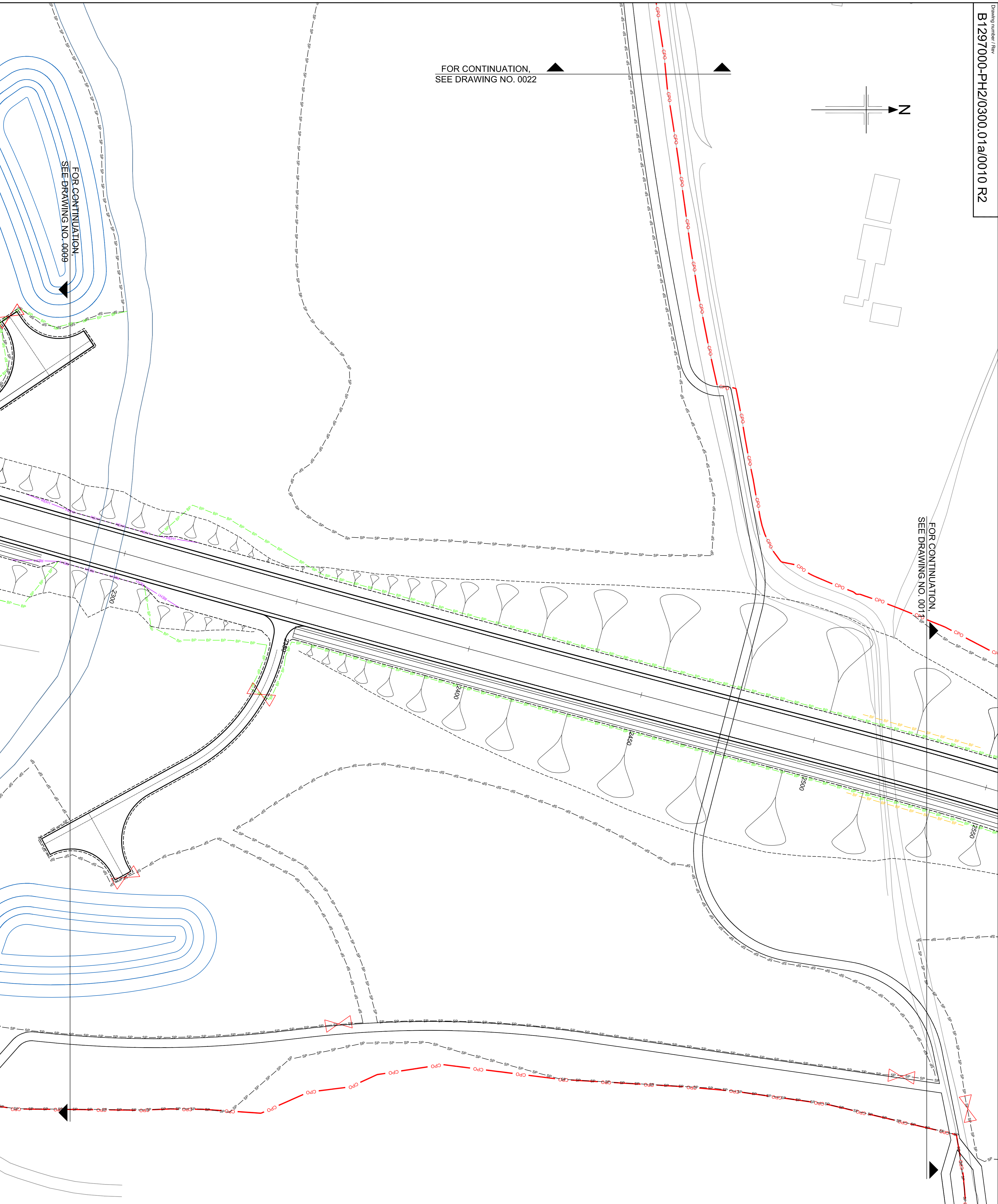

**NOTES**

1. Refer to drawing number B1297000/0300.01a/0000 for Key plan. Drawings are to be read in conjunction with Appendix 3/1 Fencing, Gates and Sills.
2. Stock Proof Fencing- It has been assumed that all Agricultural fencing requires stock proof fencing; this is to be reviewed following confirmation of land use/maintenance.
3. Gates- The location and provision of gates and sills are to be agreed with the landowner.
4. Noise Barrier- to be placed on highway boundary, or offset up to 1m inside highway boundary subject to agreement with adjacent landowners.
5. Noise Barrier- Close boarded timber noise attenuation barrier.
6. Badger gates- One way badger gates to be provided along the route of the link road at a minimum of 500m spacing on both side of the link road.
7. Badger proof fencing to taper towards mammal tunnel entrances.
8. Where stock proof / noise proof fencing and badger fencing are required in close proximity a design solution to combine fence types will be considered.

**KEY**

- CPO Boundary
- Standard timber post and Rail
- Stock Proof
- Badger Proof
- Stock/Badger Proof
- Bat Fence
- Temporary Fence
- Timber Post and Wire
- Absorptive Noise Barrier
- Reflective Noise Barrier (Height - 1.8m)
- Reflective Noise Barrier (Height - 1.5)
- Herpille Fence
- Gate
- Badger Gate (2 way)
- Noise Bund
- Temporary Fencing SSSI

**SAFETY, HEALTH AND ENVIRONMENTAL INFORMATION**

In addition to the hazards/risks normally associated with the type of work detailed on this drawing, note the following:

CONSTRUCTION	MAINTENANCE / CLEANING	DECOMMISSIONING / DEMOLITION

It is assumed that all works will be carried out by a competent contractor working, where appropriate, to an approved method statement.

Reproduction from the Ordnance Survey Map with the permission of the controller of Her Majesty's stationery office Crown copyright reserved Licence No. AL 100017326



Rev	Rev./Date	Purpose of revision	Drawn	Checked	Rev'd	Apprv'd
R2	14/12/2012	ISSUE FOR INFORMATION	DM	RS	SG	RD
R1	12/11/2012	ISSUE FOR INFORMATION	DM	RS	SG	RD
RD	02/11/2012	INITIAL ISSUE	DC	DM	RS	RD

**JACOBS**  
 Simpson Hill, 6 Cherry Orchard Road, Gosport, Surrey, CR8 6BE  
 Tel: +44(0)208 666 8212 Fax: +44(0)208 681 2459  
 www.jacobs.com

Client: **HOCHTIEF** **TEVA** **WATSON**  
 Employer: **East Sussex**  
 Project: **BEXHILL TO HASTINGS LINK ROAD**

**FENCING SHEET 10 OF 32**

ISSUE FOR REVIEW

Scale	1:500 @ A1	DO NOT SCALE
Jacobs No.	B1297000-PH2	
Client no.		
Drawing number	B1297000-PH2/0300.01a/0010	R2
Rev		

This drawing is not to be used in whole or part other than for the intended purpose and project as defined on this drawing. Refer to the contract for full terms and conditions.